

OREGON CORNER RESTORATION FORM

Section 7 Township 6S Range 8W

County Polk Date 6-11-86

Corner Designation

*Quarter Corner
Section 7 ONLY.*

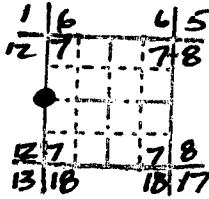

- Condition Report Only
- Not Found
- Renewed
- Unrecorded
- Surveyed In
- Referenced Out

Previous Renewals/Surveys, etc. Armstrong 1856, Fenton
November 1887, Maloney March 1889, Hollingsworth, State Parks
1968.

Monument(s) & Accessories Found: (Condition and Source)

Monument Detail

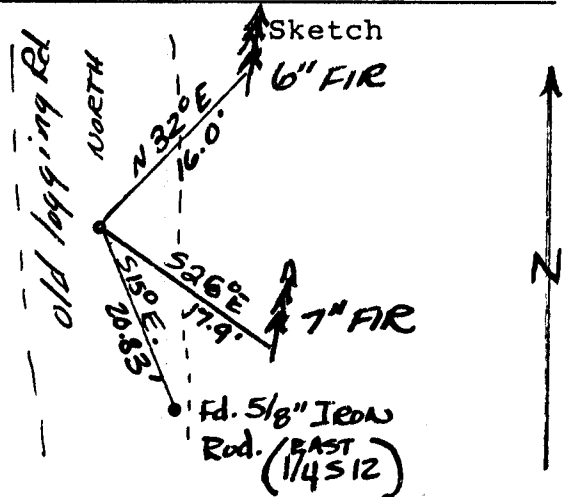
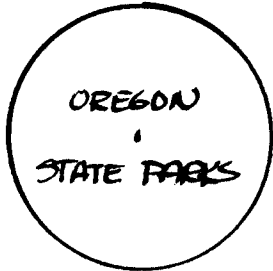

Monument Set (Procedures and Description)

Set: 5/8" x 30" iron rod with yellow plastic cap marked "Oregon
State Parks." A proportionate distance between renewed N 1/16
and G.L.O. Sec. Cor.

New Accessories

6" fir N 32°E-16.0' blazed and scribed "1/4 S7 BT"
7" fir S 26°E-17.9' blazed and scribed "1/4 S7 RS 691 BT"
Attached parks corner tags to both BT's.
Plain orange carsonite post 5.0' east.

Location & Comments

Van Duzer Corridor Compass Declination 20 1/2°
Bearing and distances Firm/Agency Oregon State
by steel tape and Parks and Recreation Division
hand compass. Address 525 Trade St. SE
Salem, OR 97310
Party Chief R. Hemmer
Notes R. Hemmer
Witness Barry Bittner
Harold Hanson

Surveyor's Seal

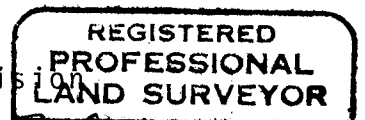

John E. Hollingsworth

